

# Attachment 6-1

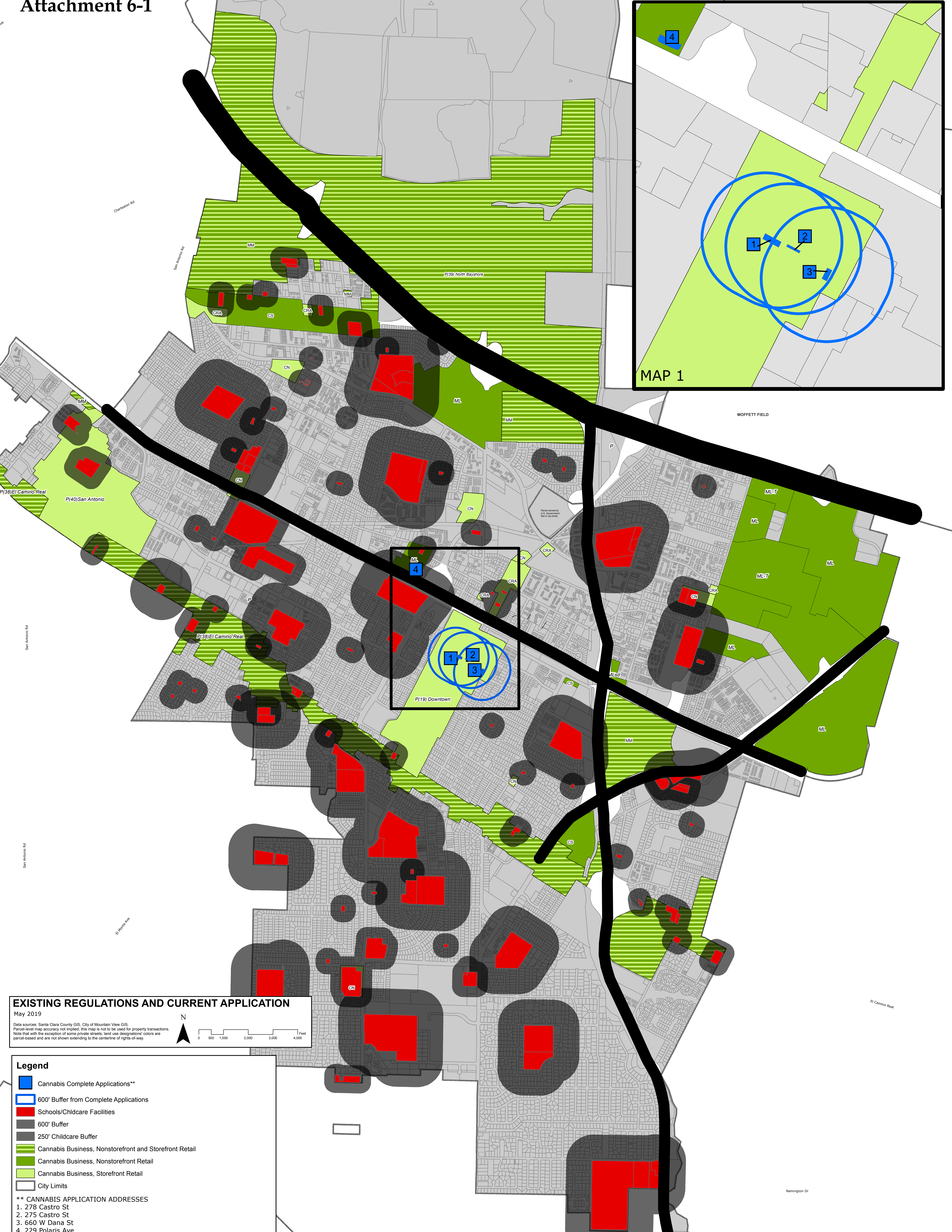

**EXISTING REGULATIONS AND CURRENT APPLICATION**  
 May 2019  
 Data sources: Santa Clara County GIS, City of Mountain View GIS  
 Parcel-level map accuracy not implied; this map is not to be used for property transactions.  
 Note that with the exception of some private streets, land use designations' colors are parcel-based and are not shown extending to the centerline of rights-of-way.

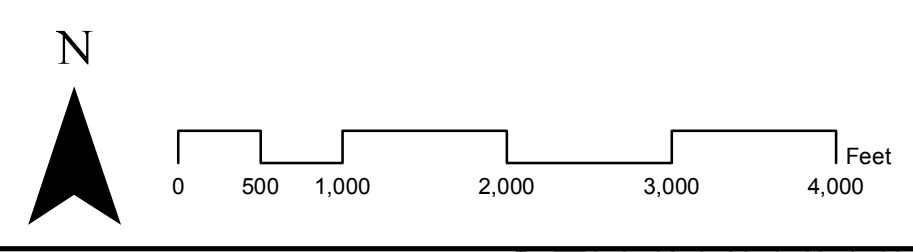

- Legend**
- Cannabis Complete Applications\*\*
  - 600' Buffer from Complete Applications
  - Schools/Childcare Facilities
  - 600' Buffer
  - 250' Childcare Buffer
  - Cannabis Business, Nonstorefront and Storefront Retail
  - Cannabis Business, Nonstorefront Retail
  - Cannabis Business, Storefront Retail
  - City Limits
- \*\* CANNABIS APPLICATION ADDRESSES**
1. 278 Castro St
  2. 275 Castro St
  3. 660 W Dana St
  4. 229 Polaris Ave

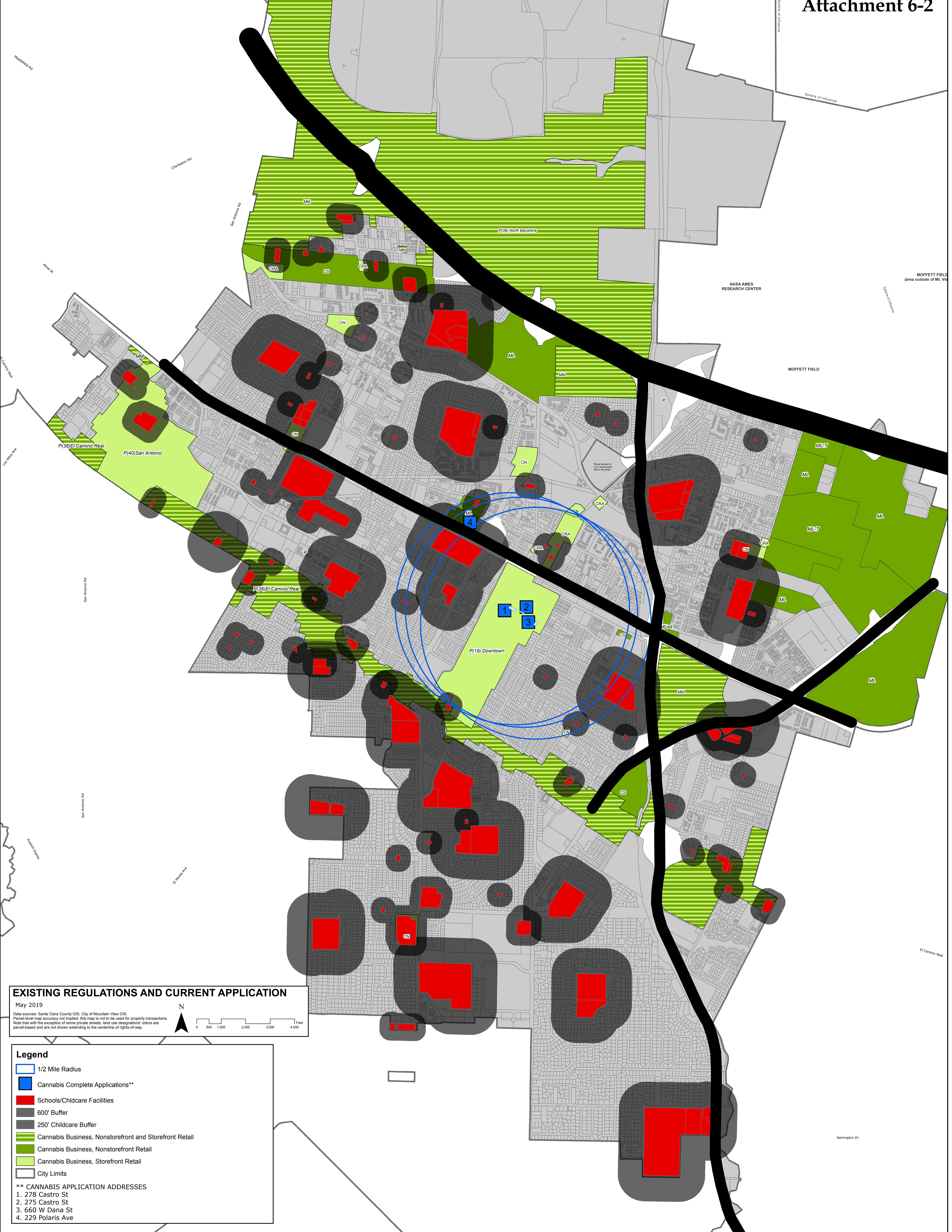

**EXISTING REGULATIONS AND CURRENT APPLICATION**

May 2019  
 Data sources: Santa Clara County GIS, City of Mountain View GIS  
 Parcel-level maps accuracy not implied; this map is not to be used for property transactions.  
 Note that with the exception of some private streets, land use designations' colors are parcel-based and are not shown extending to the centerline of rights-of-way.

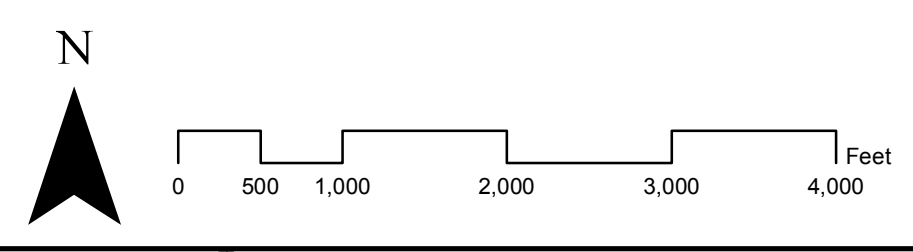

- Legend**
- 1/2 Mile Radius
  - Cannabis Complete Applications\*\*
  - Schools/Childcare Facilities
  - 600' Buffer
  - 250' Childcare Buffer
  - Cannabis Business, Nonstorefront and Storefront Retail
  - Cannabis Business, Nonstorefront Retail
  - Cannabis Business, Storefront Retail
  - City Limits
- \*\* CANNABIS APPLICATION ADDRESSES**
1. 278 Castro St
  2. 275 Castro St
  3. 660 W Dana St
  4. 229 Polaris Ave