



Potential Bike + Pedestrian Path

Conceptual - for discussion only

Not to scale

Note: Not to scale; for information only

Proposed bike and pedestrian path easement provided on neighboring property

Approximate area for requested bike and pedestrian public access easement

2700 El Camino Real Development Project (Mountain View)

Project Site

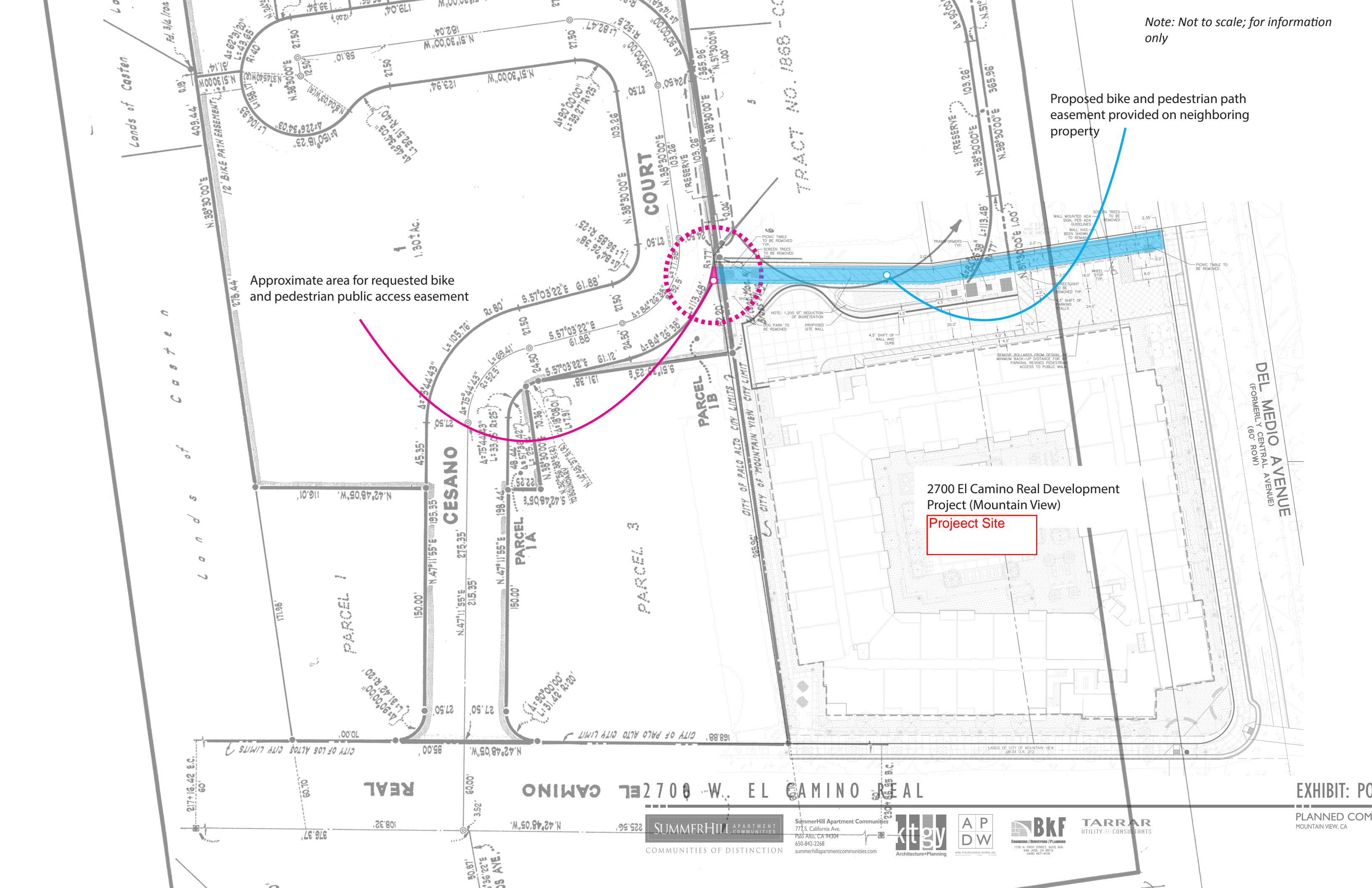

EXHIBIT: PO

PLANNED COM
MOUNTAIN VIEW, CA

SUMMERHILL APARTMENT COMMUNITIES
COMMUNITIES OF DISTINCTION

SummerHill Apartment Communities
777 S. California Ave.
Palo Alto, CA 94304
650-842-2268
summerhillapartmentcommunities.com

ktgy
Architecture+Planning

AP DW

BKF
ENGINEERS | SURVEYORS | PLANNERS
1720 N. FIRST STREET, SUITE 600
SAN JOSE, CA 95131
(408) 467-9100

TARRAR
UTILITY CONSULTANTS

“Cesano Court is a designated future bike boulevard in the City of Palo Alto’s adopted 2012 Bicycle and Pedestrian Transportation Plan and there’s a general goal to improve bike/ped connectivity to Mountain View in the San Antonio Center/El Camino area.

- Jarrett Mullen | Associate Transportation Planner | City of Palo Alto (8/29/2016)

Recommended Facilities and Conditions | 6-3

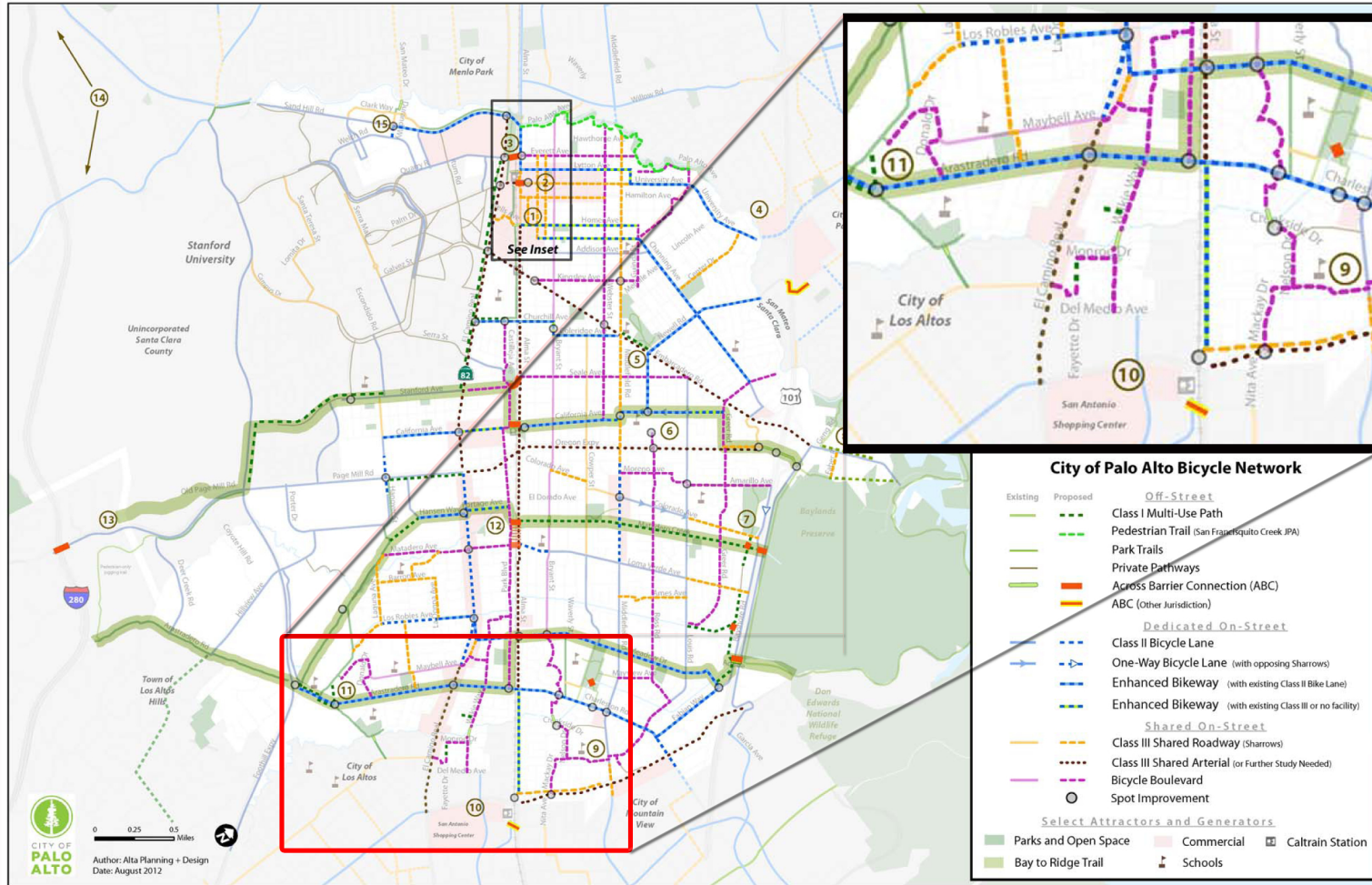

Map 6-1. Proposed Bikeway Network