

**From:** [Adrian Cosoroaba](#)  
**To:** [City Council](#)  
**Subject:** Fwd: May 10th final decision for the 555 West Middlefield Project  
**Date:** Thursday, April 28, 2022 2:06:58 PM  
**Attachments:** [image.png](#)

**CAUTION:** EXTERNAL EMAIL - Ensure you trust this email before clicking on any links or attachments.

Hello Council members,

We are concerned as residents on Cypress Point Drive of this project.  
Please see the following:

**Problems with the Current Design:**

1. **LOSS OF TREE BUFFER on Hwy 85.** Avalon will cut the tree buffer (including **heritage trees**) and put new units against Hwy 85. Resulting in exposure to **toxic airborne pollutants and noise for the next 20-30 years.**
2. **UNHEALTHY CONCENTRATIONS of PM2.5** in dust emissions from demolition, construction for the next **7+ years.**
3. **TRAFFIC HAZARD and DENSITY at dead end street** They will build a **435 underground car parking garage and 225 units** at the end of Cypress Point Dr.



← More information here: <http://perivision.net/Project555/>

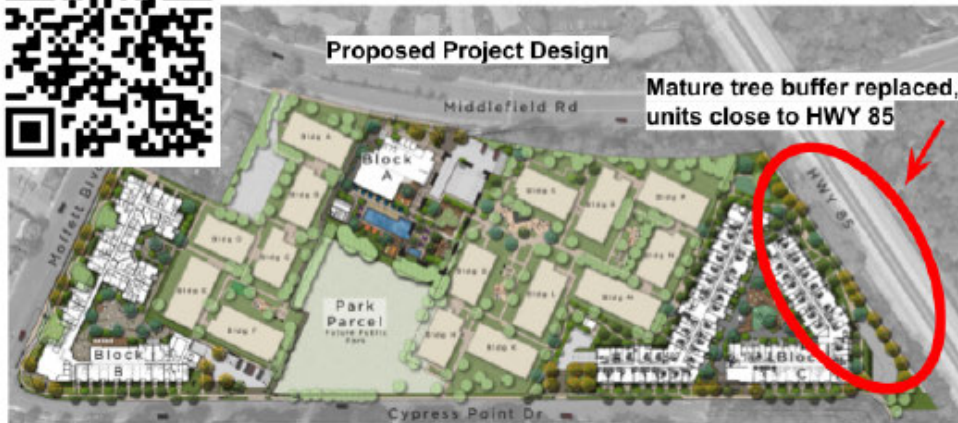

**Solution:**

**Move 24 units** against Hwy 85 towards Moffett. Avalon proposed 70%+ of its Cypress Point Dr. parking to be at the very end of the street. **Move more parking to Moffett.**

Thank you for your consideration.

Adrian Cosoroaba



**From:** [Junko Tsuchida](#)  
**To:** [City Council](#)  
**Subject:** May 10th final decision for the 555 West Middlefield Project  
**Date:** Thursday, April 28, 2022 5:22:38 PM  
**Attachments:** [image.png](#)

**CAUTION:** EXTERNAL EMAIL - Ensure you trust this email before clicking on any links or attachments.

Dear Council members,

We are concerned as residents on Cypress Point Drive of this project.  
Please see the following:

**Problems with the Current Design:**

1. **LOSS OF TREE BUFFER on Hwy 85.** Avalon will cut the tree buffer (including **heritage trees**) and put new units against Hwy 85. Resulting in exposure to **toxic airborne pollutants and noise for the next 20-30 years.**
2. **UNHEALTHY CONCENTRATIONS of PM2.5** in dust emissions from demolition, construction for the next **7+ years.**
3. **TRAFFIC HAZARD and DENSITY at dead end street** They will build a **435 underground car parking garage and 225 units** at the end of Cypress Point Dr.



← More information here: <http://perivision.net/Project555/>



**Solution:**

**Move 24 units** against Hwy 85 towards Moffett. Avalon proposed 70%+ of its Cypress Point Dr. parking to be at the very end of the street. **Move more parking to Moffett.**

Thank you for your understanding and consideration.

Junko Tsuchida

Mountain View

**From:** [oscar.denys](#)  
**To:** [City Council](#)  
**Subject:** Eaves on Middlefield: concern over new construction plans  
**Date:** Thursday, April 28, 2022 7:22:57 PM

---

CAUTION: EXTERNAL EMAIL - Ensure you trust this email before clicking on any links or attachments.

To whom this may concern,

As a resident of Eaves on Middlefield, I have to express my concern over the problems that arise from the new construction plans that have been proposed.

First, the loss of the tree buffer on hwy 85 will result in exposure to toxic airborne pollutants and noise.

Secondly, I am concerned about the unhealthy concentrations of PM2.5 in dust emissions as a result of the demolition and construction for the next 7+ years.

Finally, the traffic hazard and density at the dead end street that will result from the reconfiguration of the units would be a problem.

I hope these issues are taken into consideration on May 10th during the city council meeting. It would be a shame to ruin the natural beauty of this place.

Thank you for your time and consideration,

Warm regards,  
Oscar Denys

**From:** [Daniel Shane](#)  
**To:** [Ramirez, Lucas](#)  
**Cc:** [Pancholi, Diana](#); [Yau, Ellen](#); [City Council](#)  
**Subject:** The May 10 Hearing on 555 W Middlefield Road  
**Date:** Friday, April 29, 2022 8:02:51 AM

---

**CAUTION:** EXTERNAL EMAIL - Ensure you trust this email before clicking on any links or attachments.

Good morning Mayor. I just found out that the meeting 5/10 will start at 5:00pm and will be held Video Conference with No Physical Meeting Location. Please reconsider so the residents and people most impacted by the project can participate in person and masked. The residents have been at a great disadvantage throughout the process and finally we had something that benefited us, your constituents. This may be our last chance to inform, educate, and persuade all City Council members of the unmitigated and long-lasting damage, the significant health and environmental impacts that will be done by approving the current project plan design. We have submitted to the Council the scientific evidence, reports, and studies to backup our claims. We are not opposed to housing development in our community to address the housing crisis, only this one and only as currently designed. We have offered practical and sensible project alternatives that have been totally ignored by the developer. No real discussions or negotiations between the developer and residents about alternatives that would avoid the most heinous impacts to public health. Please hold the hearing in the City Hall Chambers. Please revise the Calendar. Please reply to this email. Best regards, Daniel Shane and the Cypress Point Community Preservation Group.

<https://mountainview.legistar.com/Calendar.aspx>

Sent from my iPhone

**From:** [REDACTED]  
**To:** [City Council](#)  
**Subject:** 555 W. Middlefield Rd. Project  
**Date:** Sunday, May 1, 2022 12:21:19 PM

---

**CAUTION:** EXTERNAL EMAIL - Ensure you trust this email before clicking on any links or attachments.

To City Council:

I live at the end of Cypress Point Drive in the first cul-de-sac of the two which have only Cypress Point Drive as an access in or out. The prospect of a new 435-space parking structure and 225 units across from us boggles my mind as to how we residents of the 40 townhouses at this dead-end street are going to navigate the over-quintupled amount of vehicle traffic across from us! And it will be even more jammed during construction. I am also not looking forward to the increased pollution created by both the construction and the removal of trees proposed.

I am for increased housing in Mountain View, but done properly. If this project must go forward, couldn't half of the proposed new additions and parking be instead located at the corner of Moffett Boulevard? Perhaps then more of the trees directly lining Highway 85 could be left in place to protect in some measure, at least, both CPW residents and the Avalon residents from the awful highway noise, pollution, and duration of construction. (I understand that asbestos has already been found in 555's buildings.)

Also, shouldn't there be created some access onto Middlefield Road from the new Avalon Block C to relieve CPD traffic?

I hope these and other concerns and information provided the Council by Daniel Shane, U.S. EPA, retired; the EIR; and the CPW residents will help to mitigate the problems that have been foreseen with Avalon's plans.

Sincerely,  
Carol Anthony

[REDACTED]

**From:** [REDACTED]  
**To:** [City Council](#)  
**Subject:** 555 West Middlefield Project  
**Date:** Tuesday, May 3, 2022 10:45:01 AM

---

CAUTION: EXTERNAL EMAIL - Ensure you trust this email before clicking on any links or attachments.

Hi,

I would like to record my objection to 555 West Middlefield project that is being discussed on Tuesday May 10.

My objection comes from the developer not taking into account the objections from local residents on the environmental and health impacts of their project.

They continue to focus on adding a high density development on a narrow dead end road, massively increasing traffic, as well as removing the urban forest that blocks the noise and pollution from the freeway.

Avalon have not adapted their plans based on the city and residents feedback and as such I am opposed to this development.

Thanks

Lloyd Dunckley  
[REDACTED]



**From:** [Gene Cavanaugh](#)  
**To:** [City Council](#); [Kathy Feerick](#)  
**Subject:** Avalon project at 555 W. Middlefield  
**Date:** Tuesday, May 3, 2022 2:48:39 PM

---

**CAUTION:** EXTERNAL EMAIL - Ensure you trust this email before clicking on any links or attachments.

When the project (which, overall, I support) was first proposed, there was to be underground parking near the Moffett end of Cypress Pt. Drive, and other parking garages (all underground, I believe) elsewhere.

Supposedly (and this is all hearsay) 435 underground parking spaces will be located on (apparently) the extreme end of Cypress Pt Drive. Note again that I do not know if this is accurate or not.

If it is accurate, it appears that the ONLY access will be Cypress Pt Drive.

If you are knowledgeable about that street, it is narrow with many cars parked on it, partially blocking the street, though there are some (private) drives between Cypress Point Drive and Central Avenue that offer temporary emergency access.

However, as presented to me, any sort of problem would block not only the Cypress Pointe Drive vehicle access (some 50 or so vehicles, more or less) but also the 435 vehicles in the Avalon development.

That alone seems particularly short-sighted and dangerous. I am wondering why there is no other access (such as on to Middlefield). I am also concerned by the idea that nearly 500 vehicles would have access (other than by trespassing on private drives) ONLY by a narrow, cluttered, roughly 3-4 block long dead-end street! Off hand, this sounds like a recipe for disaster!

Has thought been given to providing at least some access to Moffett or Middlefield, or at least (though I suggest this would be asking for trouble) providing parking closer to Middlefield?

If my understanding is right (and I don't know that) it would seem reckless to risk trapping that many vehicles in case of an emergency.

Marion Eugene "Gene" Cavanaugh



**From:** [Kaia Kailani](#)  
**To:** [City Council](#)  
**Subject:** Please save our trees! (555 W Middlefield Project)  
**Date:** Tuesday, May 3, 2022 6:57:04 PM

---

**CAUTION:** EXTERNAL EMAIL - Ensure you trust this email before clicking on any links or attachments.

Hello,

I am a resident at [REDACTED] in Mountain View. I purchased my home 3 years ago, and have been loving living here with my young daughter. As a single mom, I rely greatly on my community. And this community has been nothing but amazing.

However, the proposed 555 W Middlefield Project development is threatening the quality of our life to the point we might have to move to avoid the noise and eventually, the increased density.

We want to request that at least a few concessions are made.

1. Please save our trees at the end of Cypress Drive, near HWY 85. The new units could go to the other side of the project, saving mature trees and the buffer for the noise and dust.
2. Please reduce the density of parking at end of the long narrow street dead-ending into the freeway.
3. Please preserve the Centries Old Majestic Interior Redwood Trees. Please do not replace them with picnic tables!

We really appreciate your help! Please help us preserve our health and sanity during this process.

--

Thanks,  
Kaia Kailani Yekaterina Nguyen