



Figure 1. VP_13165- Removal



Figure 2. VP_11907- Removal



Figure 3. VP_11912- Removal

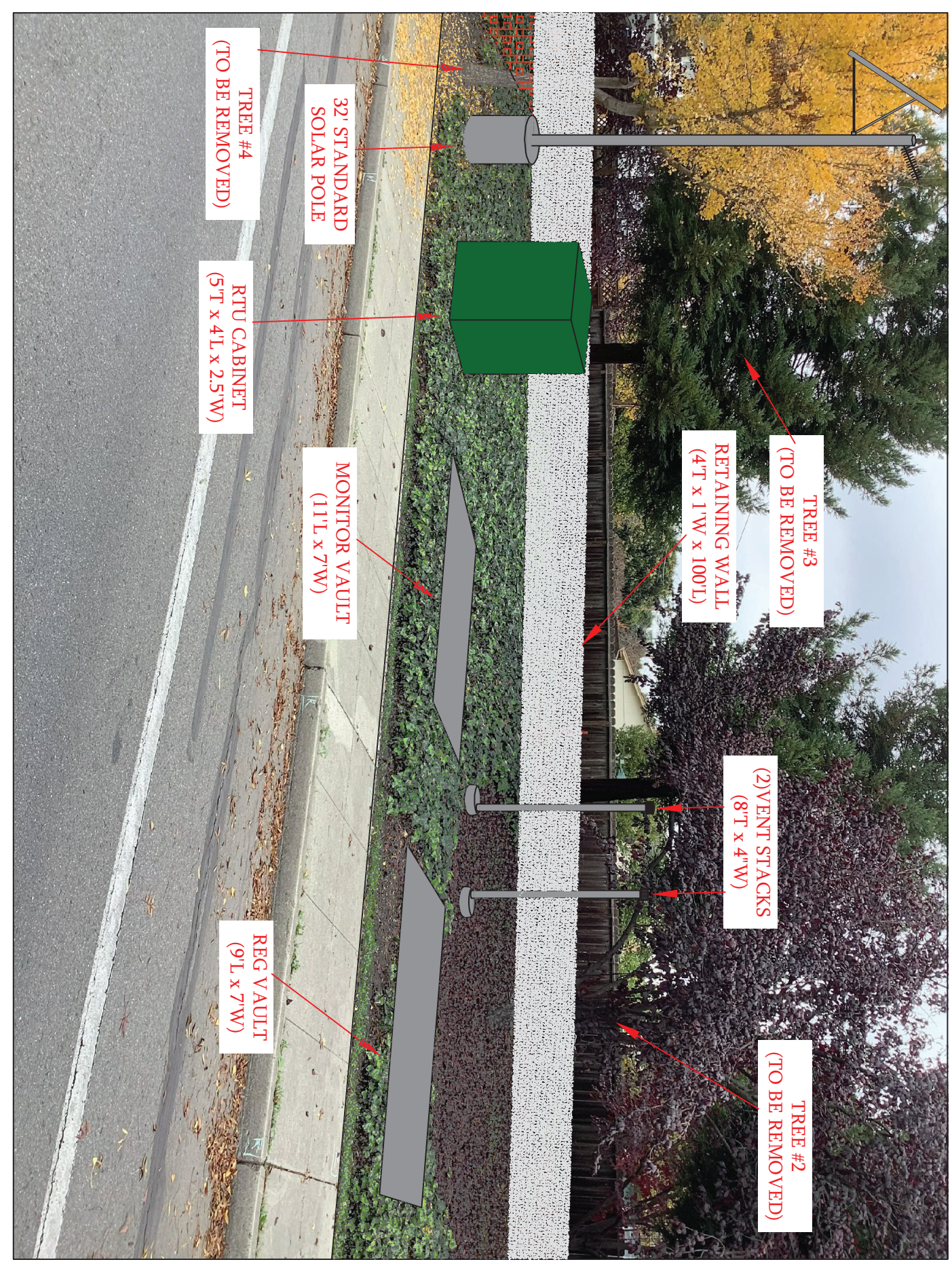

Figure 4. VP_11913- Removal



Figure 5. VP_11909- Removal

VICINITY MAP



REBUILD REG STATION B-18 (2-444)
 PERMIT SKETCH
 MIDDLEFIELD RD & LINDA VISTA AVE
 MOUNTAIN VIEW, CA

NO.	DATE	DESCRIPTION	ORDER #	GSMO	SDH6	GJGH	SUPV	APVD BY
0	9-10-20	ISSUED FOR PERMIT	31335503					

EST: GUY MENDENHALL
 ADE: RUSS MARTINO/SCOTT HART
 SUPV: GERALD GABRIEL
 REP: ANSON WONG
 PLNR: JUSTIN LAU
 SCALE: NONE

ENGINEERING AND PLANNING DEPT.
 6121 BOLLINGER CANYON RD
 SAN RAMON, CA 94583
 PHONE #: FAX #:
 PACIFIC GAS AND ELECTRIC COMPANY

CO:
 SD:
 NOTIF.: 113008323
 Other:
 SHT: 1 OF 4 SHEETS
 PM: 31335503 REV. 0

0 1 INCH