

County Office of Supportive Housing at (408) 793-0566. The Manager or a designated person will contact the shelter to confirm that the internal appeal process has been completed. The Manager will help the participant complete a written request for an external appeal. A written decision to participant and the shelter will be provided at the conclusion of the meeting. The Manager will retain copies of all written external appeal decisions. Participant must be allowed to be represented by a third-party advocate in the grievance process.

4. Participants have a right to request a reasonable accommodation in the grievance process.

## Site Plan

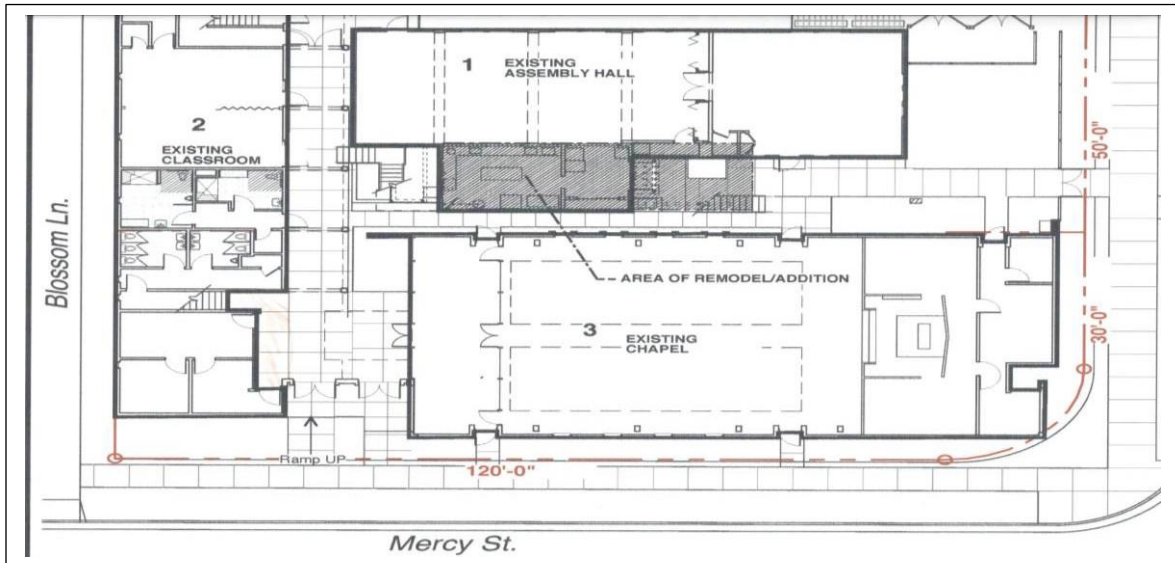

# Floor Plan

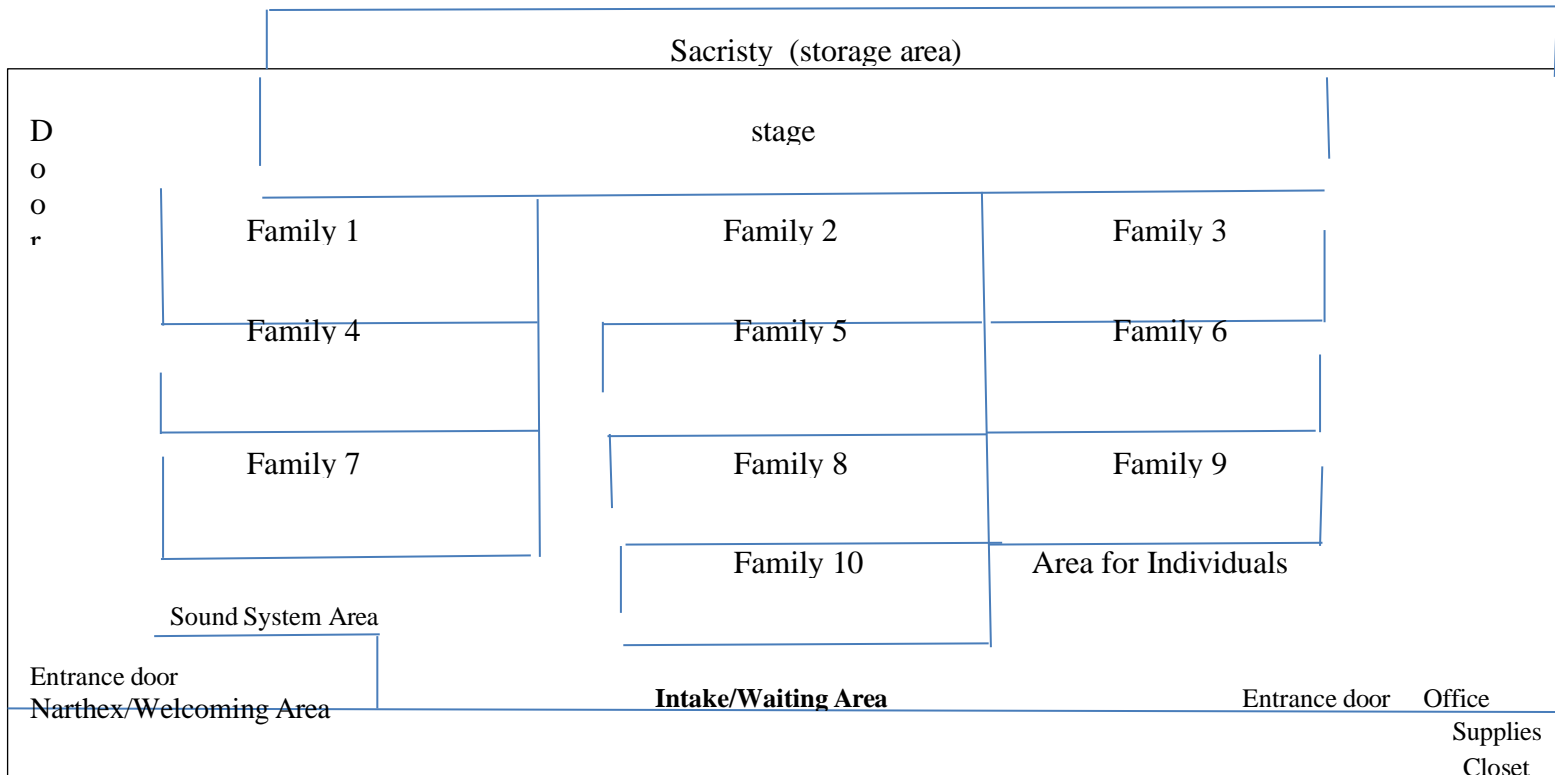

## CONTACT INFORMATION FOR THE WINTER SHELTER AT LOS ALTOS UNITED METHODIST CHURCH: FY24-25

**Any questions or concerns regarding the County Shelter site**

Office of Supportive Housing Crisis Response Team

Linda Jones: 408-278-6447  
[linda.jones@hhs.sccgov.org](mailto:linda.jones@hhs.sccgov.org)

**Supervisory District 5: Office of Joe Simitian**

County Supervisor— District five

[supervisor.simitian@bos.sccgov.org](mailto:supervisor.simitian@bos.sccgov.org)  
408-299-5050

**Reporting Shelter or Homeless Concerns**

Program Service Provider: HomeFirst

**HomeFirst**  
[Mtviewconcern@homefirstscc.org](mailto:Mtviewconcern@homefirstscc.org)

**HomeFirst Leadership**

Program Service

**VP Emergency Housing**  
Bea Ramos 408-655-2446  
[bramos@homefirstscc.org](mailto:bramos@homefirstscc.org)

**Director Emergency Housing**  
Juan Cooper 669-308-7719  
[jcooper@homefirstscc.org](mailto:jcooper@homefirstscc.org)  
Program Manager: To Be Hired