

DATE: May 8, 2024

TO: Visual Arts Committee

FROM: Ayano Hattori, Associate Civil Engineer
David O. Printy, Principal Project Manager

SUBJECT: **Public Art—Shoreline Boathouse Expansion, Project 20-39**

RECOMMENDATION

Authorize a web posting of a “Call for Artists” for the Shoreline Boathouse Expansion public art project.

BACKGROUND

The Shoreline Sailing Lake boating facility, Boathouse, and café is leased to Silicon Shores, Inc., who operates the facilities (see Figure 1). The café, called Shoreline Lake American Bistro, is more than 25 years old and requires upgrades and expansion to the kitchen and serving areas to maintain its status as a thriving recreational amenity for Shoreline at Mountain View visitors. The expansion, now currently in the design process, includes a larger kitchen, servery, new gateway, trellis, and restrooms. The expansion plan also includes the following outdoor elements:

- Larger seating area with new paving and wall surrounding bench seating;
- Larger kitchen with new exterior walls;
- New bathrooms with new exterior walls facing the parking lot; and
- New benches.

The Council Policy regarding public art provides for 2% of the construction budget be set aside for public art. For this project, the amount is \$121,200.

In 2019, the Visual Arts Committee (VAC) recommended to not move forward with public art for Fire/Police Training and Classroom Facility at Fire Station 5, Construction, Project 20-35 (Classroom Project), due to concerns that the public art would not be visible to the public at the Classroom Project location. Following the VAC’s recommendation, staff did not move forward with a call for artists for the Classroom Project and identified that staff would return to the VAC to review alternative locations to apply the Classroom Project public art funding to a different project in the Shoreline area. As identified to Council on [June 27, 2023](#), the Classroom Project public art funding will be added to the Shoreline Boathouse Expansion public art budget. The

additional amount of public art budget from the Classroom Project is \$108,000, for a total public art budget of \$229,200 for Shoreline Boathouse Expansion.



Figure 1: Project Site

ANALYSIS

Several art opportunities exist on the site. Figure 2 shows the concept layout for the boathouse expansion and suggested areas where art can be located.

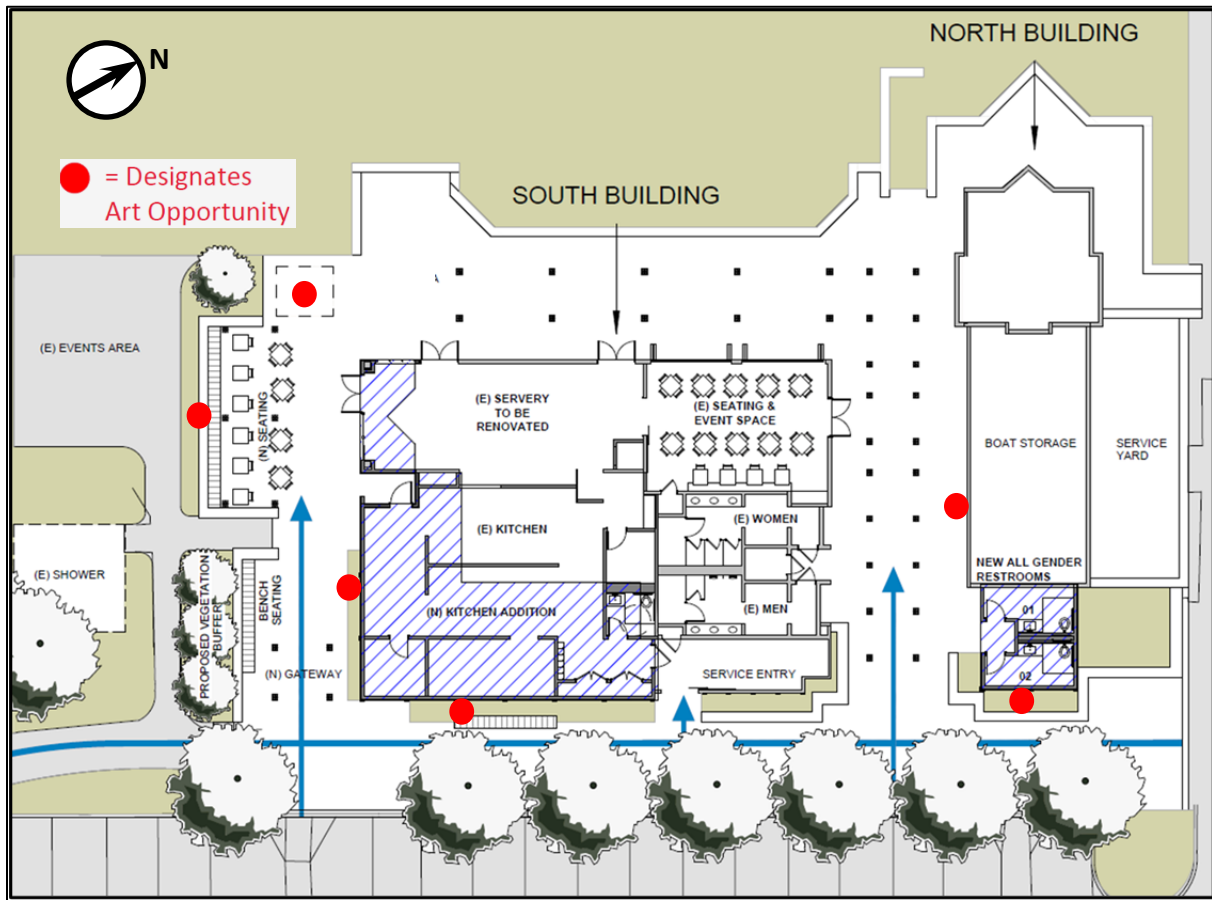

Figure 2: Schematic Plan for Shoreline Boathouse Expansion and Potential Art Locations

Art proposals should include a color sketch or photo, title, description, cost, fabrication schedule, and special requirements. Based on the proposal and costs, the VAC could select a single art piece or multiple art pieces within the budget.

Art Schedule

Based on the design schedule for the park, final decisions on the art selection should be made no later than the September 2024 VAC meeting, and the recommendation will be presented to Council for approval in October 2024. The design consultant will incorporate the approved public art in the construction documents for coordination between the artist and construction contractor. The project will bid in early 2025 and complete construction in 2026.

The art schedule is as follows:

July 26, 2024	Artist proposal deadline
August 16, 2024	Deadline for VAC to jury proposals
September 11, 2024	VAC meeting to make artist selection
October 8, 2024	Council approves art recommendation
Late 2026	Art installation

AH-DOP/6/PWK
976-05-08-24M-1

cc: ACM/CDD(A), EVM, PWD(A), APWD(A)—Byrer, PPM—Printy, ACE—Hoang, File 21-60