



Permit Sheet *(for office use only)*

LOCATION OF TREE (address): 573 Carla Court

VERIFIED:

- Liquidambar #1*
- Street Tree Private Tree Property Owner Tree Type
 Circumference Map Replant Plan

CONDITION OF TREE(S) AND CONDITIONS AFFECTING THE TREE(S):

Limb failures on tree impact less than 10 percent of the canopy. Future pruning can manage the potential for limb failure. Tree is approximately 16 feet away from home foundation and no evidence of damage was found. Paver walkway can be repaired without significantly impacting root system. Does not meet ordinance criteria for removal.

RECOMMEND APPROVAL

RECOMMEND DENIAL

Mark Z
Arborist

11-19-24
Date (MM/DD/YY)

APPROVED

DENIED

[Signature]
Forestry Manager

11/19/24
Date (MM/DD/YY)

APPROVED REPLANT PLAN:

No. of Trees to Replant: N/A Species: _____ Size: _____

Location of Replant: _____

Timeline for Removal: _____

Timeline for Replant: _____

EFFECTIVE DATE: _____ (permit expires two years from effective date)

ACTIONS:	DATE	STAFF
Notice posted on trees	_____	_____
Applicant notified of decision by mail:		
<input type="checkbox"/> APPROVED or <input type="checkbox"/> DENIED	_____	_____
If no appeals, the permit mailed.	_____	_____



LOCATION OF TREE (address): 573 Carla Court

VERIFIED:

Liquidambar #2

- Street Tree, Private Tree, Property Owner, Tree Type, Circumference, Map, Replant Plan

CONDITION OF TREE(S) AND CONDITIONS AFFECTING THE TREE(S):

Tree in good condition. Future pruning can manage the potential for limb failure. Tree is approximately 16 feet away from home foundation and no evidence of damage was found. Paver walkway can be repaired without significantly impacting root system. Does not meet ordinance criteria for removal.

RECOMMEND APPROVAL

RECOMMEND DENIAL

Arborist signature and name

11-19-24 Date (MM/DD/YY)

APPROVED

DENIED

Forestry Manager signature and name

11/19/24 Date (MM/DD/YY)

APPROVED REPLANT PLAN:

No. of Trees to Replant: N/A Species: Size:

Location of Replant:

Timeline for Removal:

Timeline for Replant:

EFFECTIVE DATE: (permit expires two years from effective date)

ACTIONS:

DATE

STAFF

Notice posted on trees

Applicant notified of decision by mail:

APPROVED or DENIED

If no appeals, the permit mailed.

Application submitted on: November 6, 2024 by Wanda Cheung

Request Name: Remove dangerous liquidambar trees in front yard



Heritage Tree Removal Permit Application

Project Information

COMPLETE

Address information is verified using the City of Mountain View's address database, which can be accessed using the [City's online GIS](#). If your address does not appear after typing in the address numbers, please contact the Mountain View Building Division at 650-903-6313. Please note: Street directions are abbreviated (e.g. West = W) and no punctuation is included (e.g. 500 W Castro St.)

Project Address *

573 Carla Ct

REQUIRED: Address must be entered and selected from the dropdown list to populate all required address fields. If all required address fields are not populated, the application will not be accepted.

Project City *

Mountain View

Project State *

CA

Project Zip Code *

94040

Project Assessor Parcel Number

19317030

Heritage Tree Removal Information

COMPLETE

Property Type *

Single-Family Residential Property

Where is the Heritage Tree(s) located on the property? *

On private property

Number of Trees Proposed to be Removed *

2

Proposed Tree Removal No. 1

COMPLETE

Type of Tree Species *

liquidambar

Tree Circumference (in inches, measured 54" above grade) *

86"

Reason for Tree Removal:

The tree is a danger to the house and my neighbors as it drops its limbs with no prior warning. I had the tree removed soon after I bought the house (2/2022) but

Current Condition of Tree (Check all that apply) *

- Tree is in poor health
- Tree is in danger of falling
- Tree is diseased with pests, insects, and/or beetles
- Tree is near end of the life span
- Tree is dead
- Tree has poor structure and/or an unbalanced canopy
- Tree is in good or fair health

Is the tree impacted by construction activity or existing conditions? Check all that apply: *

- Tree does not have proper growth space
- Tree removal is necessary to construct new improvements
- Tree is interfering with utility services (.g. electricity, gas, sewer, and/or water lines)
- Tree is growing in close proximity to a structure(s) and causing damage (or will in the near future)
- Other reason

Please briefly describe your effort(s) to preserve the tree *

I had licensed arborist prune the tree in February 2022. To prune it further back so it is not a danger to the people sailing or walking in the court would mean

Proposed Tree Removal No. 2

COMPLETE

Type of Tree Species *

liquidambar

Tree Circumference (in inches, measured 54" above grade) *

72"

Reason for Tree Removal:

This tree is very close to tree 1. Removing that tree will certainly damage this one. Plus, the fact that these two tall trees are very close together (20' at the

Tree is in poor health

Current Condition of Tree (check all that apply): *

- Tree is in danger of falling
- Tree is diseased with pests, insects, and/or beetles
- Tree is near end of the life span
- Tree is dead
- Tree has poor structure and/or an unbalanced canopy
- Tree is in good or fair health

Is the tree impacted by construction activity or existing conditions? Check all that apply: *

- Tree does not have proper growth space
- Tree removal is necessary to construct new improvements
- Tree is interfering with utility services (.g. electricity, gas, sewer, and/or water lines)
- Tree is growing in close proximity to a structure(s) and causing damage (or will in the near future)
- Other reason

Please briefly describe your effort(s) to preserve the tree. *

I had licensed arborist prune the tree in February 2022. I placed mulch around the front yard to help retain moisture. There are three sprinkler zones on the

Tree Replanting Information

COMPLETE

No. of Trees Proposed to be Replanted *

1 preferably male gingko closer to the sidewalk and more consistent with the rest o

The City's standard replacement requirement is 2 new trees for every 1 heritage tree removed. An in-lieu fee may be authorized if replacement is not feasible.

Estimated Time to Plant Replacement Trees (following permit approval) *

30 Days

Property Owner Information

COMPLETE

Property Owner is logged in as current user.

First Name *

Wanda

Last Name *

Cheung

Address *

573 Carla Court

Address (Continued)

City *

Mountain View

State *

CA

Zip Code *

94040

Email

[REDACTED]

Phone Number

[REDACTED]

Applicant Information

COMPLETE

Applicant is current logged in user.

Applicant First Name *

Wanda

Applicant Last Name *

Cheung

Applicant Phone Number *

[REDACTED]

Applicant Email Address *

[REDACTED]

Applicant Address *

573 Carla Court

Applicant Address (Continued)

573 Carla Court

Applicant City *

Mountain View

Applicant State *

CA

Applicant Zip Code *

94040

Signature

COMPLETE

I hereby declare that I have read and understood the above information, and:

I acknowledge that:

1. I understand and agree that clicking on the box above identifies that I am the authorized applicant, as designated by the property owner(s), on this permit;
2. I hereby declare, under penalty of perjury, that the information stated on forms, plans, documents, and other materials submitted herewith in support of the application is true and correct to the best of my knowledge; and
3. It is my responsibility to inform the City, through the staff assigned to my permit, of any changes to information

represented in this application submittal, including subsequent submittals, in a timely fashion.

Applicant: Wanda Cheung

Signature date: 2024-11-06 01:52 PM

Payment Details

[Home](#) | [Profile](#)

The tree is a danger to the house and my neighbors as it drops its limbs with no prior warning. I had the tree pruned soon after I bought the house (2/2022) but within a year, it dropped a very large and heavy limb that had to be cut up to move it. This past Sunday (11/3), it dropped another large limb. And then Monday (11/4) morning at 2:00 am it dropped at 3 very large limbs (the quantity and motion triggered my doorbell camera) that were very large and heavy and from tall heights (the highest limb was over 20 ft from the ground and the lowest limb was over 10 ft from the ground). I have photos of extent of the aftermath that I would like to submit. Luckily, it just missed the roof and there was no car parked under it on the driveway else it would have severely damaged the car. Now I am very worried about it dropping more limbs and damaging the house or even killing someone since the limbs are heavy and falling from tall heights. Part of the canopy extends into the court where neighbors walk on the sidewalk and park their cars. Moreover the tree is too close to the house and the roots are starting to threaten the foundation.

This tree is very close to tree 1. Removing that tree will certainly damage this one. Plus, the fact that these two tall trees are very close together (20" at the grade) mean that the canopy is very unbalanced and makes the tree a danger during high winds. Moreover, this tree is also too close to the house and has roots threatening the foundation. The roots have already significantly uprooted the pavers in the walkway in front of the house.

1 preferably male ginkgo closer to the sidewalk and more consistent with the rest of the houses in the court

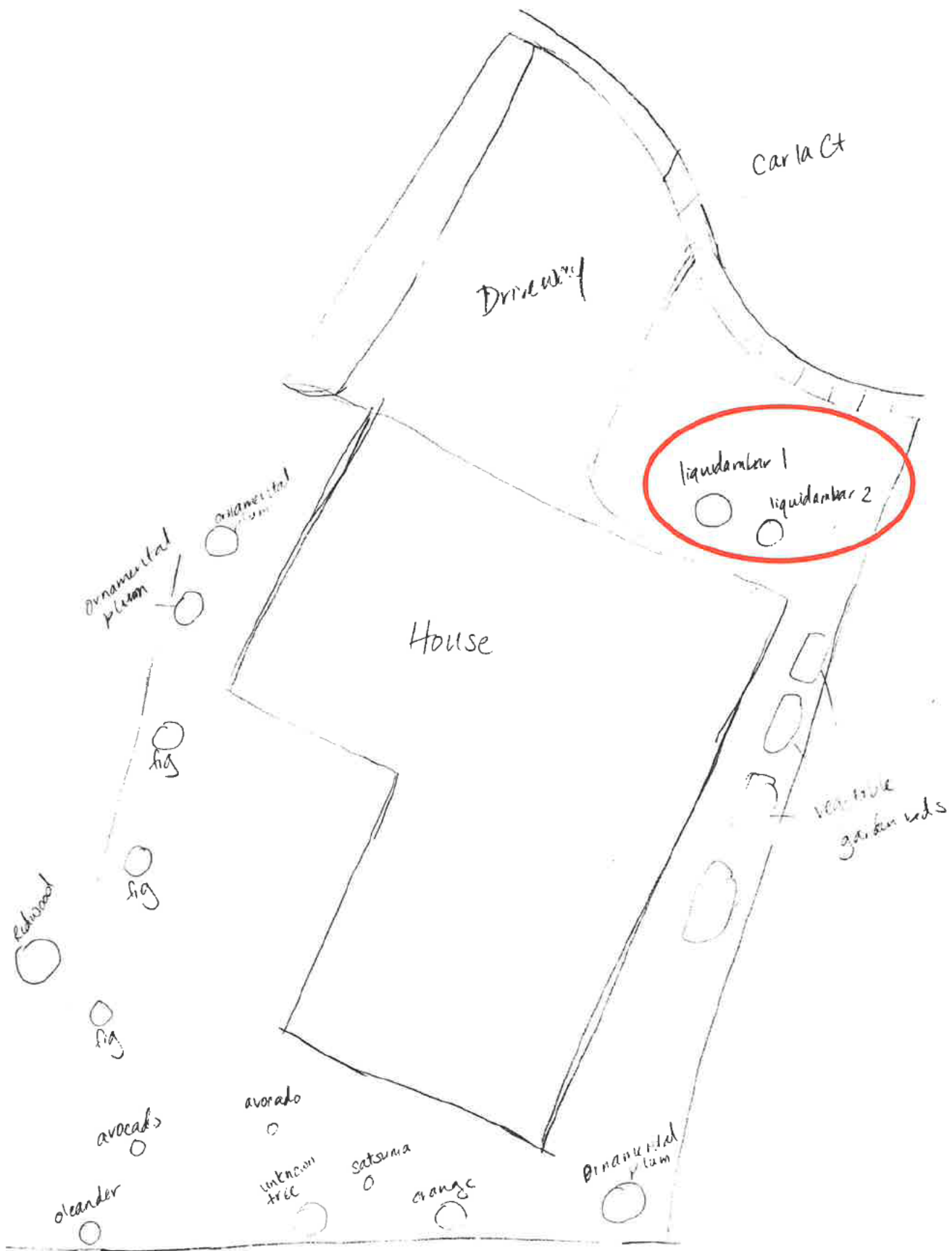

Carla Ct

Driveway

liquidambar 1
liquidambar 2

House

vegetable garden beds

ornamental plum
ornamental plum

fig

fig

fig

Redwood

avocado

oleander

avocado

inkberry tree

satsuma

orange

Birmingham