



## CITY OF MOUNTAIN VIEW

### CALL FOR ARTISTS

**APPLICATION DEADLINE: May 1, 2017, by 11:00 PM (PST)**

**Submit online via CaFE at [www.callforentry.org](http://www.callforentry.org)**

The City of Mountain View Visual Arts Committee (VAC) seeks to commission an artist or an artist team to create the design (DESIGN ONLY) for public artwork in a newly redesigned part of the Mountain View Public Library. Artists will provide a resume, examples, and a final design proposal as part of their application. **Eligible artists and artist teams must be residents of the states of California, Oregon or Washington.**

All associated costs to visit the Library, prepare and submit a proposal or to attend the Visual Arts Committee meeting shall be borne by the artist. Applicants should only submit applications directly through this [callforentry.org](http://www.callforentry.org) website, no other form of application will be accepted.

### APPLICATION

Applications will be accepted from **Thursday, April 6, 2017, at 8:00 AM (PST) to Monday, May 1, 2017 by 11:00 PM (PST).** **APPLY EARLY**, Applications will not be accepted after the 11pm, Monday, May 1st deadline and only the first 120 applications will be accepted (whichever comes first).

### ELIGIBILITY

The call is open to all professional artists/artist teams over the age of 18 residing in the states of California, Oregon or Washington.

### APPLICATION REQUIREMENTS

All applications must be submitted online via CaFE at [www.callforentry.org](http://www.callforentry.org), an online application system for calls for entry. There is no charge for artists to apply or use CaFE. Applications that are mailed, faxed, or hand-delivered will not be considered, as this is an online system.

All applications should include the following:

- **Artist Resume**
- **Three (3) to Ten (10) Images** of current work. All images must be of glass artwork.
- **Proposal** Please include a final proposal. The proposal should include the artwork design, the type of application process and the approximate cost of application.
- **Annotated Images** descriptions. Please include the following information: title, date of art piece, dimensions and type of media.

All applicants should allow adequate time to submit their applications. To get additional assistance using CaFE , please contact WESTAF by calling 303-629-1166 or via email at [cafe@westaf.org](mailto:cafe@westaf.org).

## SELECTION

All proposals and examples of past and current artwork must be submitted through the CaFE (Call for Entry) website between April 6, 2017 and May 1, 2017, where they will be reviewed and juried by the Mountain View Visual Arts Committee (VAC). The VAC would like to encourage applications by artists residing in the states of California, Oregon, and Washington only, all applications received from outside these areas will be declined.

The VAC will jury the proposals in May 2017 and will submit the finalists to the architect and Public Works Department for review. When the budget for the project is approved by the Mountain View City Council a single finalist will be chosen and then contacted.

## PROJECT DESCRIPTION

### Background

The City of Mountain View is a community of approximately 78,000 people located on the San Francisco Peninsula. Over the years, the City has instituted an arts program and built a collection of art using a public/private partnership, community involvement, and some public funds. A major component of this program is a City policy known as the 1 Percent for Art Program which requires that 1 percent of all major City capital improvement projects over \$1 million be spent on public art related to the project. This program is administered by the Visual Arts Committee (VAC), a seven-person, Council-appointed advisory committee that will recommend two to three alternatives to the City Council, whose decision is final. More information on the public art program is available on the City's website at: [www.mountainview.gov/council/bcc/visual.asp](http://www.mountainview.gov/council/bcc/visual.asp).

### Project Budget

The budget for the Mountain View Library Project, **which is for the design of the art only**, is \$5,000. The artwork will be created by a separate entity that must be able to apply the artwork for \$25,000 or less.

### Project Site

#### Mountain View Public Library

The Mountain View Public Library is located at 585 Franklin Street in downtown Mountain View and it services people of all ages throughout the community. The current, reconstructed building was opened in October of 1997. The renovation project is limited to expanding the Children's Services space in the first floor and increasing Public seating areas on the second floor. A glass curtain wall will be constructed between the main lobby and newly expanded Children's Services space with a double door and a smaller "playful" doorway for children to enter. This is the location for the public art. See THEME/DESIGN GUIDELINES below for further information.

The City Council will consider approval of construction funding for the renovation project in spring 2017. Should the construction phase not be funded at this time, the City may continue the process to

select the art and hold the execution of an agreement with the artist until funding has been approved. The City does not guarantee a contract with the selected artist and may change the location and art medium in the future if funding is delayed.

Applicants are encouraged to visit the site in person or online to get a better sense of the building architecture and its surrounding area.

### **Theme/Design Guidelines**

The City is seeking art designs for the glass curtain wall to be constructed at the Library main lobby. Art designs can be etched, frosted or have a material applied to create a children's themed art. Artwork should be appropriate public art suitable to a wide and diverse audience. It should have meaning relative to its setting and to the Mountain View community.

The new glass wall and doorways will divide the lobby area from the renovated children's area. It's desirable to have children's themed artwork. The tempered glass wall will have 2 full paneled sections, smaller paneled sections, a section with a child height doorway, and a panel with full size double doors. Each full panel section is approximately 8 feet high by 6 feet long.

Included for your reference is a PDF of the site plans. The site plans shows the floor plan, architects drawings and the architect's depiction of the glass wall to which the art design will be placed. The pages of the PDF are described as follows:

Page 1 - This shows current Library floor plan, the green area highlights the current children's section.

Page 2 - This shows the new, expanded floor plan for the children's section which is highlighted in green. The new glass wall is located on the left side of this drawing and is curved.

Page 3 - The drawing on the left shows the two doorways, the small children's doorway on the left is made out of wood and the doorway on the right are double glass doors. The picture above shows what the small children's doorway might look like **(the design can include the small doorway but there should be no design on the wood doorway itself).**

Page 4 - This is the architect's depiction of the glass wall, small wood doorway, and double glass doors as they would be installed. The design should include as many of the glass panels as possible but NOT on the glass double doors.

The artwork design may be applied in a variety of different ways but shall be within a budget of \$25,000. The types of artwork design can include any number of different applications including, but not limited to, etching, frosting, and material application. The design should have a children's theme; incorporate most of the glass wall panels; should not be completely solid, allowing patrons to look through the glass. No art on the adult full size doorway will be allowed.

Art design can incorporate the text "Children's Services" as part of the way finding aspect.

### **Proposal**

**As part of this application the artist should submit a final proposal.** The proposal should include the artwork design, the type of application process and the approximate cost of application.

### **Selection Process**

All proposals and examples of past and current artwork must be submitted through the CaFE (Call for Entry) website between April 6, 2017 and May 1, 2017, where they will be reviewed and juried by the Mountain View Visual Arts Committee (VAC). The VAC would like to encourage applications by artists residing in the states of California, Oregon, and Washington only, all applications received from outside these areas will be declined.

The VAC will jury the proposals in May 2017 and will submit the finalists to the architect and Public Works Department for review. When the budget for the project is approved by the Mountain View City Council a single finalist will be chosen and then contacted.



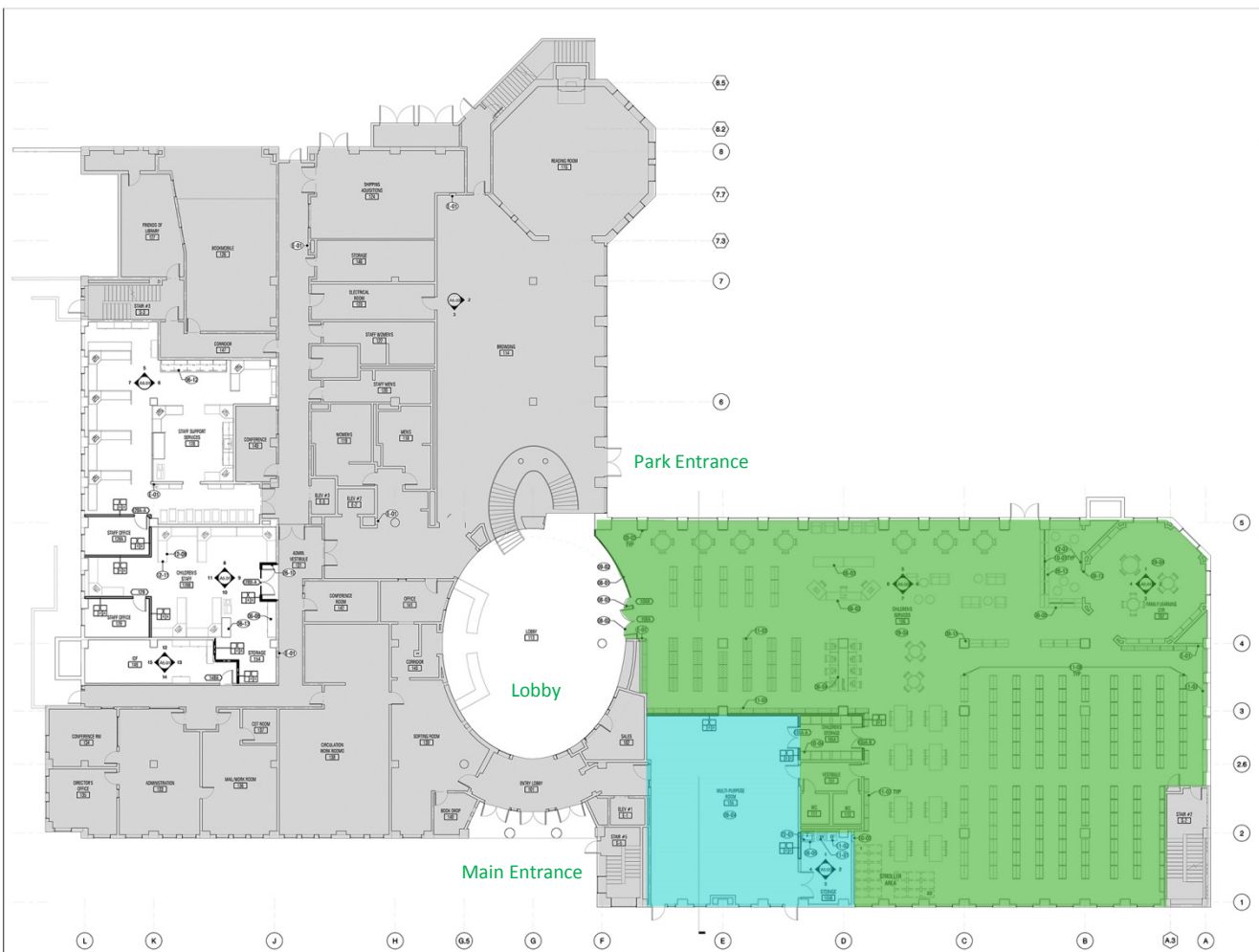

11 1ST FLOOR PLAN - New + Existing



In the side of what had seemed to be a snow-bank stood a solid-looking little door, painted a dark green. An iron bell-pull hung by the side, and below it, on a small brass plate, neatly engraved in square capital letters, they could read by the aid of moonlight:—  
MR. BADGER.

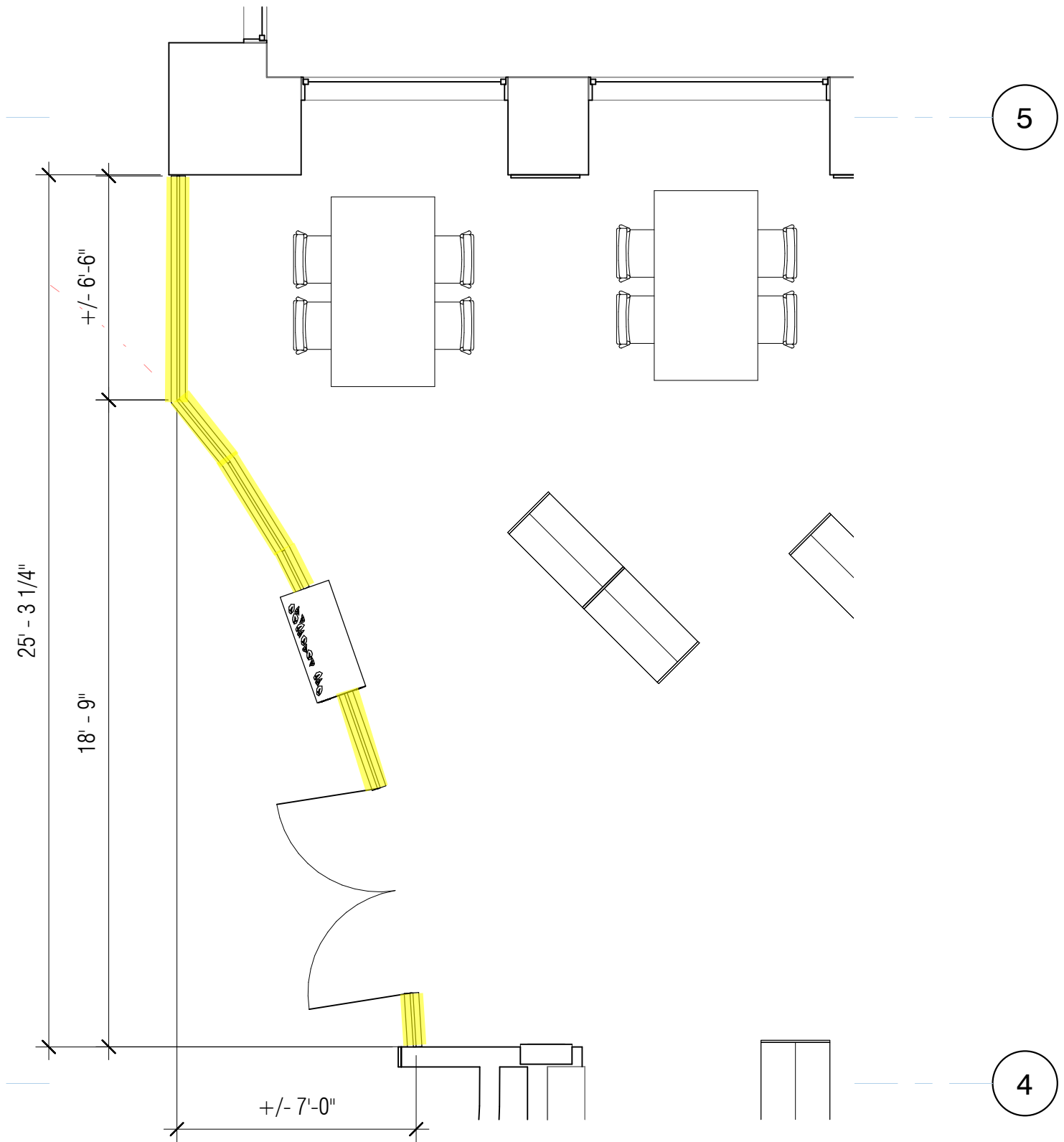
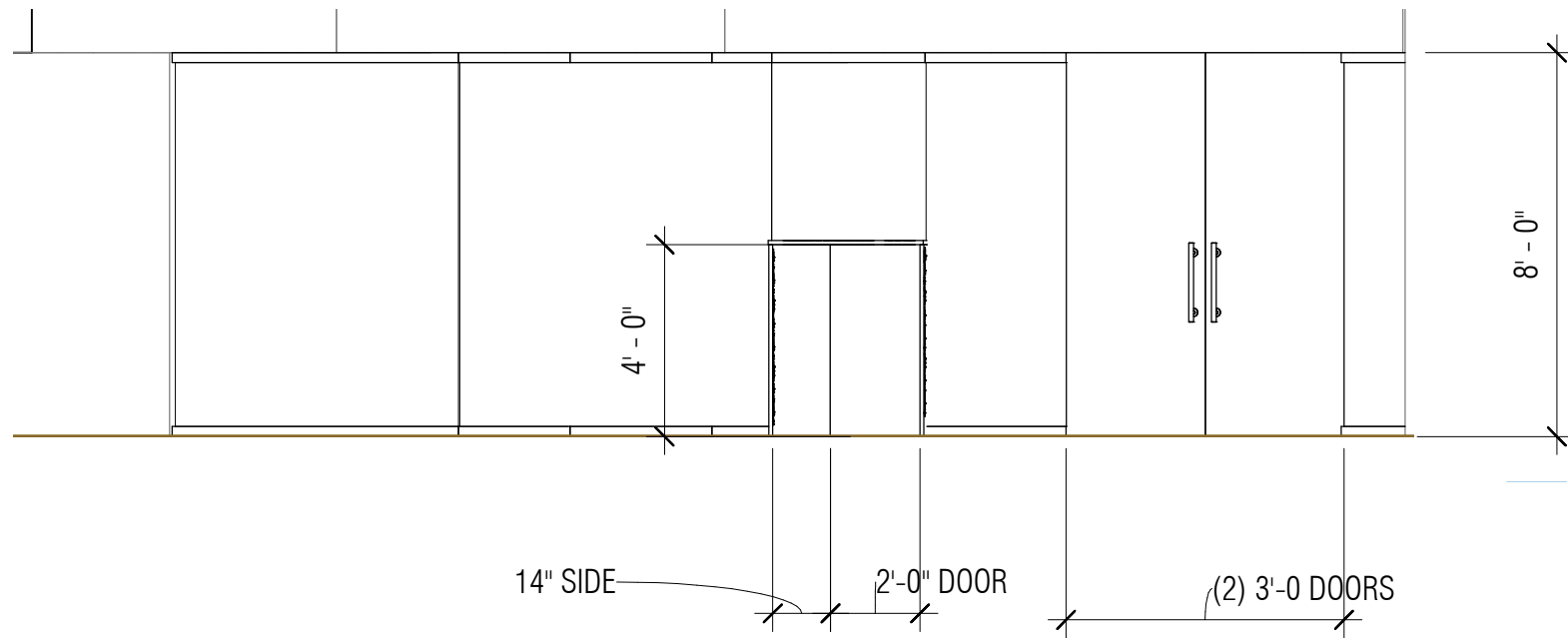

## 1ST FLOOR PLAN - ENLARGED - ENTRY

1/4" = 1'-0"





PROPOSED GLASS WALL SYSTEM WITH STANDARD DOOR AND CHILD DOOR ENTRY  
PLAIN GLASS